



advanced FLOW engineering™  
 P.O. Box 1719  
 Corona, CA 92878  
 Support: 951-493-7100  
 aFepower.com

## Intake Kit Installation Instructions: 2009 Ford F-150; '07-'09 Expedition; '07-'09 Navigator V8-5.4L Stage 2

|                      |   |  |  |
|----------------------|---|--|--|
| Kit P/N: 51/54-11622 | <b>Tools Required:</b><br>5/16" Nut Driver<br>4mm or 5/32" Allen Key<br>1/4" Nut Driver | <b>Parts List:</b><br>1 Air Filter (Pro-5R™ 24-91040 or Pro Dry S™ 21-90053)<br>1 Housing<br>1 Coupler, Elbow (05-00464)<br>1 Coupler, Hump (05-00565)<br>1 Tube, Intake 3-1/2"<br>1 7/16" Trim Seal @ 24 5/8" L<br>1 Adaptor, Filter<br>3 Clamp, #056<br>5 Screws, Button Head M6 | 1 Torx Bit, T20<br>1 Clamp, #064<br>5 Washers, Wavy M6 |
|----------------------|---|--|--|



Complete Kit w/ Parts

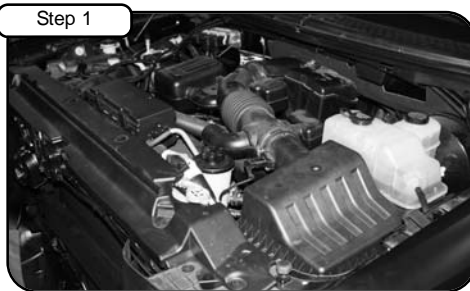

**Step 1**  
 Complete Stock Intake.  
 Disconnect the battery.

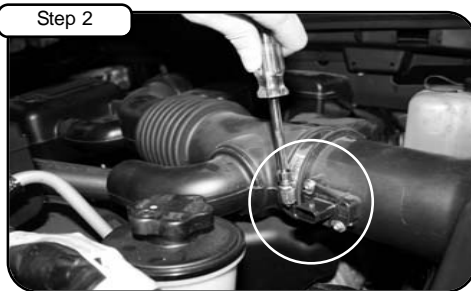

**Step 2**  
 Disconnect the MAF sensor harness. Loosen the clamp on the airbox tube using a 5/16" nut driver.

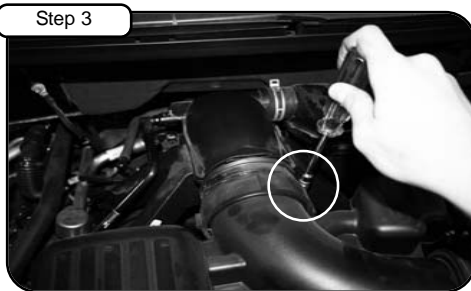

**Step 3**  
 Loosen the clamp on the throttle body tube using a 5/16" nut driver.

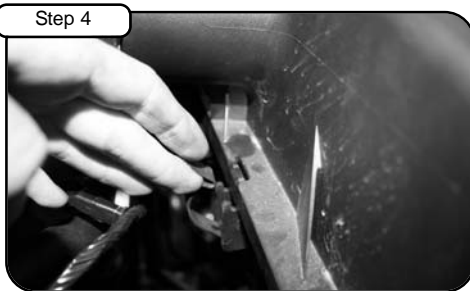

**Step 4**  
 Disengage the 3 clips which secure the upper portion of the airbox. Remove the center clip which is not used with the aFe intake.

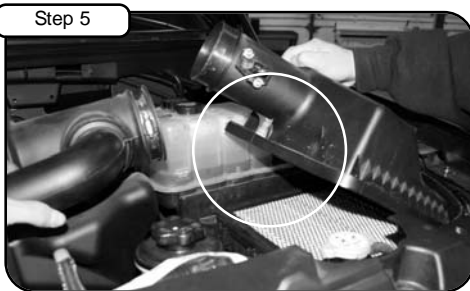

**Step 5**  
 Remove the upper portion of the airbox from vehicle.

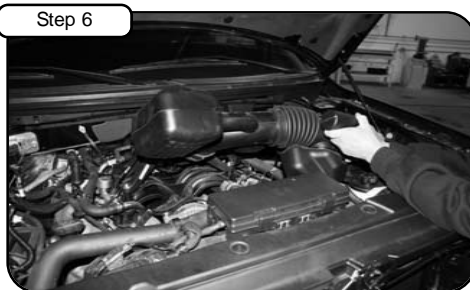

**Step 6**  
 Remove the stock intake tube from the vehicle.

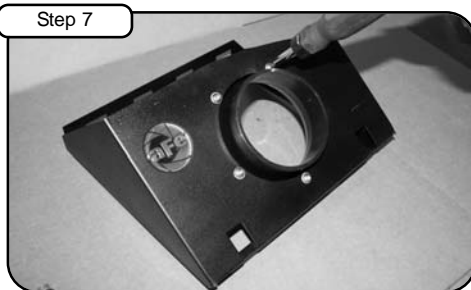

**Step 7**  
 Attach the filter adaptor to the new housing using button head screws provided and tighten using a 4mm allen key.

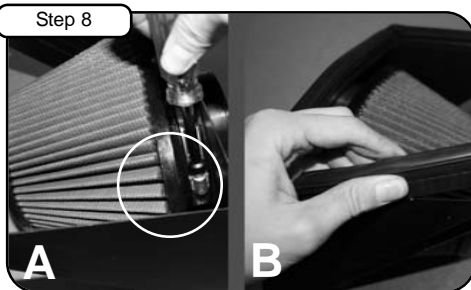

**Step 8**  
 A) Attach the air filter to the adaptor and tighten using a 5/16" nut driver. B) Attach trim seal to housing.

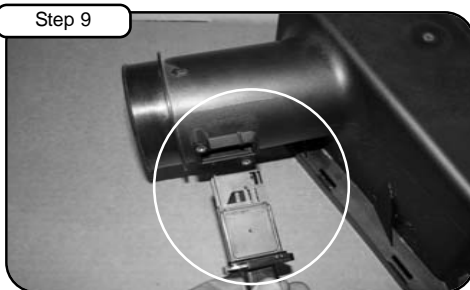

**Step 9**  
 Remove the MAF sensor from the airbox using a T-20 torx bit and save hardware for later install.

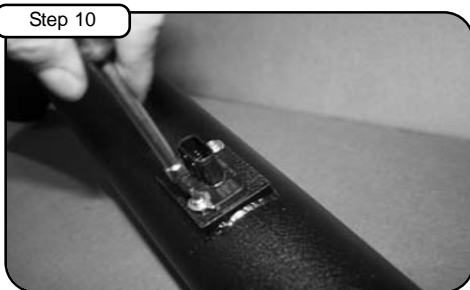

**Step 10**  
 Install the MAF sensor into the new tube using the screws removed in step 9.



**Step 11**  
 Attach the coupler with the clamps provided to the filter adaptor. Do not tighten clamps.

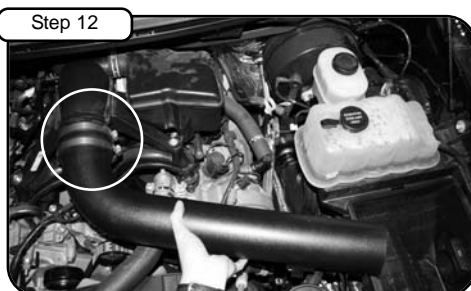

**Step 12**  
 Attach the intake tube to the vehicle with the straight coupler and clamps provided. Do not tighten clamps.

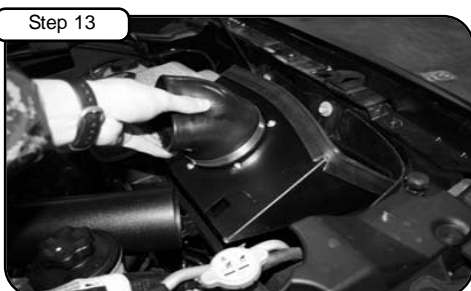

**Step 13**  
 Install the new housing into vehicle. Engage the clips, secure housing and connect the intake tube to coupler.

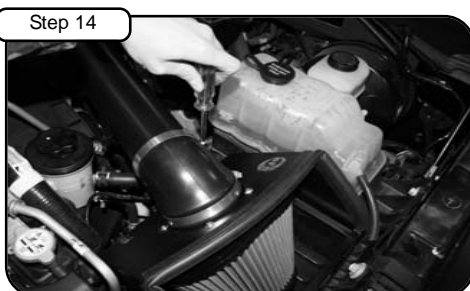

**Step 14**  
 Position tube and tighten all clamps using 5/16" nut driver. Re-connect MAF sensor harness.



**Step 15**  
 Your Intake is now complete. Please check all clamps periodically and tighten as needed. Thank you for choosing aFe power.